

# Connecto® I Channel - Outside width 130 mm - with slotted galvanized steel grating class A15

Code: DRP178G

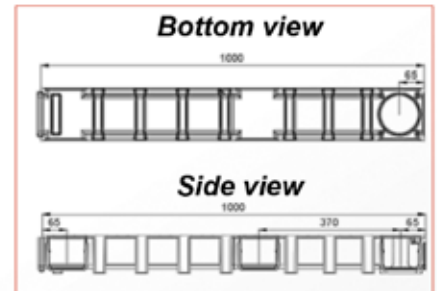
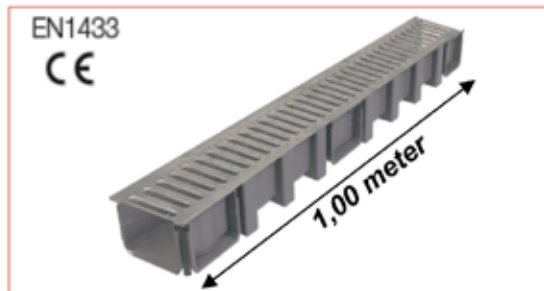
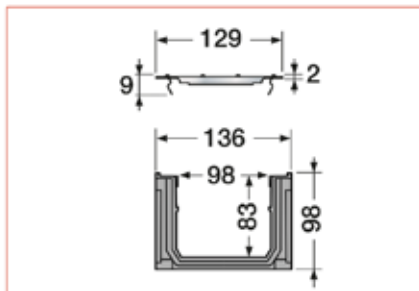

### FUNCTION:

The drainage channel is designed to drain run-off water. In accordance with EN1433 standard and the CE marking, it can be used in private areas for all building applications, the environment of home, parks and gardens in class A15.

### DESCRIPTION:

It consists of:

- an injected polypropylene body in light grey colour with male/female interlocking system
- one slotted galvanized steel grating class A15

 STCAN  
SVCAN

 NAT178  
NAV178

 PSCVT  
PSCVV

### ACCESSORIES:

The network connection can be realized thanks to the following PVC accessories:

- end cap/end or lateral outlet Ø 100 or 110: NAT178 or NAV178
- vertical outlet Ø 100 or 110: STCAN or SVCAN
- sump unit with outlet Ø 100 or 110: PSCVT or PSCVV

### CHARACTERISTICS:

- Resistance class: A15
- Effective width: 98 mm
- Effective depth: 83 mm
- Grating type: Galvanized steel
- Drainage surface: 260 cm<sup>2</sup>/ml
- Hydraulic section: 81 cm<sup>2</sup>
- Opening dimensions: 9 / 82 mm
- Weight: 2,8 kg



### IMPLEMENTATION:

1. The channel body makes it possible to carry out 90° angles by interlocking.
2. See the scheme opposite

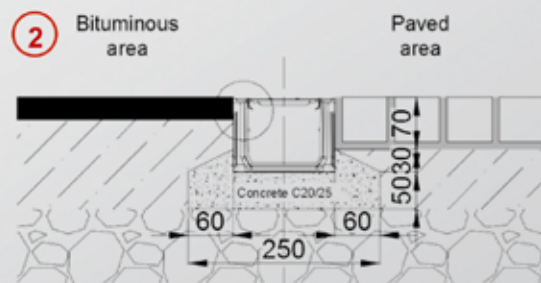

### QUALITY - ENVIRONMENT:

 ISO 9001  
ISO 14001  
ISO 50001  
BUREAU VERITAS  
Certification

DATE: August 2015