

DELTA[®]-Adhesive Products

**Just what you need
for durable seams!**

Meets the most exacting requirements.
For DIN-conformable seams, seals, and repairs.



■ Cartridge
adhesives
Adhesive tapes

■ For all
DELTA[®] sheets

■ Construction
Rehabilitation

**Great strength even in the smallest detail:
The DELTA® range of adhesive products offers maximum safety from the word go!**

The right answer to any question:

DELTA® adhesive products Outstanding strength. Tailor-made.



Whenever a pitched roof is built or rehabilitated, a wide range of requirements have to be considered: protection from the wind and the weather, from rain and drifting snow is as imperative as the need to keep the heat insulation permanently functional.

Especially seals, seams, and repairs demand impeccable quality which guarantees a maximum of safety down to the smallest detail: DELTA® offers a comprehensive range of adhesive products for each of the various applications of DELTA® insulation underlays, waterproofing sheets, soft sheathing, and draught and vapour barriers. And each and every product is sure to meet the most stringent demands in terms of adhesive strength, longevity, and ease and speed of handling.

Whenever you use any of the DELTA® adhesive products, make absolutely sure that the substrate is dry, free of dust and grease, and stable!



Products

made for professional users.



DELTA®-adhesive tapes – photo: DELTA®-REFLEX – greatly simplify the installation of draught and vapour barriers.

Why not benefit from the DELTA® System.

The DELTA® range of adhesives offers perfect accessories for each DELTA® product. Together, DELTA® sheets for exterior and interior applications and our perfectly designed DELTA® accessories form an integrated system. Whether you are building or rehabilitating a pitched roof, DELTA® System makes your work easy and offers optimum safety for a long time to come.

You will find detailed information on the elements of the DELTA® System in the relevant DELTA® System guides.

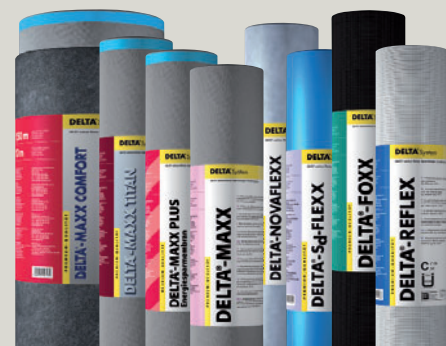

Adhesive products for all DELTA[®] sheets

DELTA[®]-MULTI-BAND



All-round adhesive tape featuring extreme adhesive strength. Highly age-resistant.

- Recommended application
- All DELTA[®] sheets for interior and exterior application.
 - For sealing overlaps and penetrations and repairing tears.

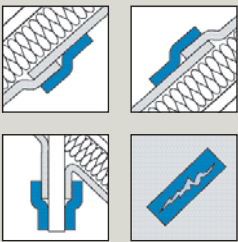

Substrate temperature (conditioned storage recommended)	from + 5 °C	
Dimensions	Width:	60 mm, 100 mm
	Length:	25 m
Functional temperature range - 40 °C to + 80 °C		

DELTA[®]-POLY-BAND



Aluminised, tear-resistant adhesive tape. Highly age-resistant. High adhesive strength.

- Recommended application
- Sealing overlaps between DELTA[®]-REFLEX draught and vapour barrier sheets on the outside.



Workable	from + 5 °C	
Dimensions	Width:	100 mm
	Length:	100 m
Functional temperature range - 40 °C to + 80 °C		

DELTA[®]-KOM-BAND



Pre-compressed, acrylate-dipped soft foam sealing strip with contact bar.

- Recommended application
- Sealing seams between DELTA[®] draught and vapour barriers and plaster surfaces using contact bars in conformance with DIN 4108 part 7.
 - Sealing seams between DELTA[®] draught and vapour barriers and rising building elements.

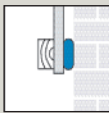

Workable	from + 5 °C	
Dimensions	Width:	15 mm
	Length:	8 m
	Thickness:	4/17 mm
Functional temperature range - 40 °C to + 80 °C		

DELTA®-TIXX



Cartridge adhesive for draught-proofing seams between vapour-barrier sheets and masonry. No contact bar. For interior application.

Recommended application

- For all DELTA® draught and vapour barriers.



Workable	0 °C to + 40 °C, store away from frost (+ 5 °C to + 30 °C)
Yield	c. 7 r.m. per cartridge c. 13/14 r.m. per tubular bag
Contents	310 ml per cartridge 600 ml per tubular bag

Functional
temperature range - 40 °C to + 80 °C

DELTA®-THAN



Permanently elastic special-rubber cartridge adhesive. For outside application.

Recommended application

- Sealing and bonding DELTA® sheets.
- For greater seam safety.

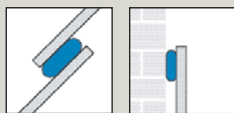

Workable	from + 5 °C, open-time limit: 30 minutes
Yield	c. 7 r.m. per cartridge
Contents	310 ml
Functional temperature range	- 30 °C to + 80 °C



Adhesive products for rainproofing roof underlays

DELTA[®]-PREN



Special adhesive featuring high viscosity and age resistance.

Recommended application

- Sealing DELTA[®]-FOXX overlaps and flashings.
- Pretreating surfaces for the application of DELTA[®]-FLEXX-BAND.

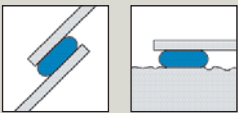

Workable	- 5 °C to + 35 °C
Contents	850 g/bottle
Yield	c. 50 r.m. per bottle
Functional temperature range	- 40 °C to + 80 °C

DELTA[®]-FLEXX-BAND



Stretchable high-strength special cloth faced with a bitumen-rubber adhesive.

Recommended application

- Stretchable tape for sealing building elements outside and inside.
- For roof windows, vent pipes, and cables.
- Pre-stretch. Detach only part of the non-stick backing if required by the application. For sealing vapour barriers, nail the tape down and cover with plaster (after moistening the cloth).

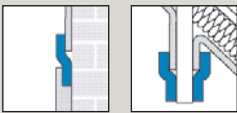

Workable temperature (conditioned storage recommended)	from + 5 °C
Dimensions	Width: 100 mm Length: 10 m
Functional temperature range	- 40 °C to + 80 °C



Adhesive products for various applications

DELTA®-SCHAUM-BAND



Nail sealing strip off the roll.
Made of VPE foam, single-faced.

Recommended application

- Sealing nail penetrations.
- Single-faced adhesive sealing tape.
- Apply to sheet surfaces or counter-battens.

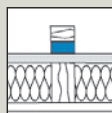

DELTA®-FIXX



Special PUR nail sealing compound.
Comes in a bottle.

Recommended application

- Sealing counterbatten contact surfaces.

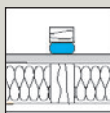

DELTA®-DICHT-BAND



Single-faced adhesive tape of flexible
PE foil with a plastic non-stick backing.

Recommended application

- Ideal for sealing seams between sarking membranes and/or soft sheathing and counter battens.
- When applying the tape, press it down firmly (e.g. with a roller).

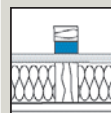

Workable	from - 5 °C
Dimensions	Width: 60 mm Length: 30 m
Functional temperature range	- 40 °C to + 80 °C

Workable	from - 5 °C, Store dry (+ 15 °C to + 25 °C)
Contents	900 ml/1000 g
Functional temperature range	- 40 °C to + 80 °C
Application rate	20 g/r.m.

Workable temperature (conditioned storage recommended)	from + 5 °C to + 25 °C
Dimensions	Width: 50 mm Length: 10 m
Storage temperature	25 °C max.
Functional temperature range	- 40 °C to + 80 °C

DELTA®-BAND



Bitumen-rubber sealing tape with an aluminium and/or lead-coloured cover.

Recommended application

- Repairing sheet metal components such as gutters.
- Repairing minor tears in all DELTA® sheets.
- Pretreat porous substrates with a primer (DELTA®-THENE) and allow to dry completely.

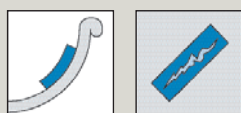

DELTA®-BUTYL-BAND



Weather-resistant, fabric-reinforced double-faced butyl-rubber adhesive tape.

Recommended application

- Permanent sealing of sheet overlaps.
- Applying sheet patches.
- Two-sided sealing of overlaps between DELTA® draught and vapour barriers.



DELTA®-TAPE FAS 60/100



Maximum-adhesion tape. Highly age-resistant.

Recommended application

- Designed for use with DELTA®-FASSADE, DELTA®-FASSADE PLUS, DELTA®-FASSADE S and DELTA®-FASSADE S PLUS.
- For sealing overlaps, penetrations and difficult flashings.

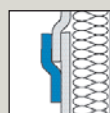

Workable	+ 5 °C to + 35 °C
Dimensions	Widths: 50/75/100/150/300 mm Length: 10 m
Functional temperature range	- 40 °C to + 80 °C

Workable	from + 5 °C
Dimensions	Width: 15 mm Length: 15 m
Functional temperature range	- 40 °C to + 80 °C

Substrate temperature (conditioned storage recommended)	from + 5 °C
Dimensions	Width: 60 mm, 100 mm Length: 20 m
Functional temperature range	- 40 °C to + 80 °C

Which bonding system for what?

DELTA® adhesives													
DELTA® sheets	DELTA®-MULTI-BAND	DELTA®-POLY-BAND	DELTA®-KOM-BAND	DELTA®-TIXX	DELTA®-THAN	DELTA®-PREN	DELTA®-FLEXX-BAND	DELTA®-SCHAUM-BAND	DELTA®-FIXX	DELTA®-DICHT-BAND	DELTA®-BAND	DELTA®-BUTYL-BAND	DELTA®-TAPE FAS
DELTA®-MAXX COMFORT	●	-	-	-	▲**	-	▲	●	-	●	■	-	-
DELTA®-MAXX TITAN Thermomembrane	●	-	-	-	▲**	-	▲	●	●	●	■	-	-
DELTA®-MAXX PLUS Energy saver membrane	●	-	-	-	▲**	-	▲	●	●	●	■	-	-
DELTA®-MAXX	●	-	-	-	▲**	-	▲	●	●	●	■	-	-
DELTA®-VENT N PLUS DELTA®-VENT N	●	-	-	-	●	-	▲	●	●	●	-	-	-
DELTA®-FOXX PLUS DELTA®-FOXX	●	-	-	-	●	●	▲*	●	●	●	■	-	-
DELTA®-VENT S PLUS DELTA®-VENT S	●	-	-	-	●	●	▲	●	●	●	■	-	-
DELTA®-FOL SPF	●	-	-	-	●	-	▲	-	-	-	■	●	-
DRAGOFOL	●	-	-	-	●	-	▲	-	-	-	■	●	-
DELTA®-FOL PVG PLUS DELTA®-FOL PVG	●	-	-	-	●	●	▲	●	●	●	■	●	-
DELTA®-REFLEX PLUS DELTA®-REFLEX	○	●	●	●	-	-	▲	-	-	-	-	○	-
DELTA®-LUXX	●	-	●	●	-	-	▲	-	-	-	-	○	-
DELTA®-NOVAFLEXX	●	-	●	●	●	-	▲	-	-	-	-	○	-
DELTA®-S _g -FLEXX	●	-	●	●	●	-	▲	-	-	-	-	○	-
DELTA®-DAWI GP	●	-	●	●	-	-	▲	-	-	-	-	○	-
DELTA®-TRELA PLUS DELTA®-TRELA DELTA®-Enka®-VENT	-	-	-	-	●	●	-	-	-	-	-	-	-
DELTA®-TERRAXX	-	-	-	-	-	-	-	-	-	-	-	-	-
DELTA®-FASSADE PLUS/S PLUS DELTA®-FASSADE/S	○	-	-	-	●	○	▲	-	-	-	-	○	●

● our recommendation

○ alternative option

▲ for flashings

■ repairs only

- not recommended

* prime with DELTA®-PREN

** underside only

The DELTA® roof portfolio

Dörken makes your life easier. Systematically.

■ Insulation underlays, sarking and

waterproofing sheets, soft sheathing

DELTA®-MAXX COMFORT

DELTA®-MAXX TITAN Thermomembrane

DELTA®-MAXX PLUS Energy saver membrane

DELTA®-MAXX

DELTA®-VENT N PLUS/DELTA®-VENT N

DELTA®-FOXX PLUS/DELTA®-FOXX

DELTA®-VENT S PLUS/DELTA®-VENT S

DELTA®-FOL SPF

DRAGOFOL

DELTA®-FOL PVG PLUS/DELTA®-FOL PVG

■ Draught and vapour barriers

DELTA®-REFLEX PLUS/DELTA®-REFLEX

DELTA®-LUX

DELTA®-DAWI GP

DELTA®-NOVAFLEXX

DELTA®-S_d-FLEXX

■ Separation layers

DELTA®-TRELA PLUS/DELTA®-TRELA

DELTA®-Enka®-VENT

DELTA®-TERRAX

■ Facing sheets

DELTA®-FASSADE S PLUS/DELTA®-FASSADE S

DELTA®-FASSADE PLUS/DELTA®-FASSADE

■ Ridge and arris roll

DELTA®-VENT ROLL

DELTA® is a registered trademark of Ewald Dörken AG, Herdecke, Germany.

DELTA®



DELTA® System ...

... for owners:

"... What I get is a mature problem solution provided at a fair price by a top specialist in quality branded products!"

... for workers:

"... What I get is a complete system made by a single manufacturer that enables me to do anything to the owner's entire satisfaction. There is no safer way!"

... for planners:

"... I can be certain that both innovative and standard products will be used in implementing my roof and cellar plans in a systematic and forward-looking way."



Dörken GmbH & Co. KG
Wetterstraße 58
D-58313 Herdecke
Tel.: +49 23 30/63-0
Fax: +49 23 30/63-355
bvf@doerken.de
www.doerken.de

A member of the Dörken Group

■ Standard requests for tender as well as detailed installation instructions for all DELTA® products may be obtained at www.doerken.com as pdf files for you to print out and save.